



**Precision Plumbing Products**  
*"Specify with Confidence - Install with Pride"*

**LEAD FREE**

**TEMP-DE-TECH**

**VALVE SPECIFICATION**

Hot water supply temperature	185°F max
Water supply pressure static	200 psi max.
Flow rate @ 73 psi:	
Normal	greater than 6gpm
Shut-down	less than 0.1gpm
Nominal Set temperature	120°F (+/- 3°F)
Max. Operating Pressure	145 psi
Min. Operating Pressure	less than 1 psi

**INSTALLATION INSTRUCTIONS**

**ASSE 1062**

**Nominal Size 1/2"**

**Direction of flow**



Hot Water Shut-Down Valve  
 Model: TSV-500

www.pppinc.net

Proposition 65 Warning (for California Residents Only). This product contains a chemical known to the State of California to cause cancer, birth defects or other reproductive harm.

**NOTE TO INSTALLER/CONTRACTOR:** California law requires this notice to be provided to the consumer/end user of this product.

**FUNCTION**

Storage hot water systems must deliver water at a minimum of 140°F. At this temperature it takes one second for a severe burn or scald to occur! Temp-de-Tech™ is designed to ensure water is delivered at a temperature of not more than 120°F, providing it is correctly installed and operated. The bath water cannot reach higher than this temperature, thereby protecting people from hot water burns. Its' quick shut-down action also assists in prevention of scalding should the hot tap be accidentally turned on.



**STEP 1**



**STEP 2**

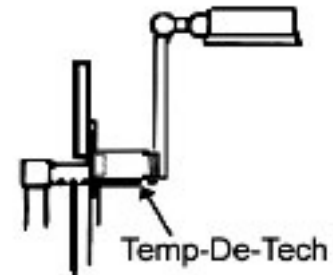

Temp-De-Tech

**INSTALLATION INSTRUCTIONS**

- Step 1 Ensure that the hot & cold bath taps are turned off. Remove the Shower fitting from the wall by turning it counter clockwise.
- Step 2 Apply the plumbers thread tape to seal the threads of your Temp-de-Tech™ & screw the Temp-de-Tech™ into the shower arm as shown below.
- Step 3 Apply plumbers thread tape to seal the threads of the wall connection & refit the shower arm onto the wall connection.

Note: YOU WILL NEED PLUMBERS THREAD TAPE.

**OPERATION**

For normal operation, first turn on the cold water to achieve the desired flow rate, then introduce hot water until the preferred temperature is reached.

**TEST**

When testing, ensure that no person is in the line of flow of water. Have a strong flow of warm water pass through the spout, then close the cold tap & observe the water shut-down. Once the shut-down has occurred this product will reduce the flow of hot water to a trickle. This continuation of water flow is necessary to allow resetting to occur. **It is recommended that this product be tested monthly.**

**RESET**

When Temp-de-Tech™ shuts down the hot water flow, turn off the hot tap, stand clear of the flow and open the cold tap. Temp-de-Tech™ will reset as soon as the hot water is purged from the pipes. Turn on the cold water to achieve the desired flow rate, and then introduce hot water until the preferred temperature is reached.

**WARNING:**

This product is designed to reduce the incidence of scalding, however hot water will trickle from the unit when shut-down occurs. Bath fittings fitted with this product should not be operated by children without parental supervision. This product may not operate properly if incorrectly installed. It is recommended that this product be replaced if test failure occurs. This product is not a substitute for Tempering Valve or Thermostatic Mixing Valve. This product is not suitable for use in Health Care Institutions.

**Precision Plumbing Products**

Division of JL Industries, Inc.

802 SE 199th Ave  
 Portland, Oregon 97233

T (503) 256-4010  
 F (503) 253-8165

www.pppinc.net





**Precision Plumbing Products**

*"Specify with Confidence - Install with Pride"*

**LEAD FREE**

**TEMP-DE-TECH**

www.pppinc.net

**VALVE SPECIFICATION**

Hot water supply temperature  
Water supply pressure static  
Flow rate  
Normal  
Shut-down  
Nominal Set temperature  
Max. Operating Pressure  
Min. Operating Pressure

**INSTALLATION INSTRUCTIONS**

185°F max  
200 psi max.  
at 73 psi  
greater than 6 gpm  
less than 0.1 gpm  
120°F (+/- 3°F)  
145 psi  
less than 1 psi

**ASSE 1062**

**Nominal Size 1/2"**

**NOTE TO INSTALLER/CONTRACTOR:** California law requires the following notice to be provided to the consumer/end user of this product. Proposition 65 Warning (for California Residents Only) This product contains a chemical known to the State of California to cause cancer, birth defects or other reproductive harm.

**FUNCTION**

Storage hot water systems must deliver water at a minimum of 140°F to prevent bacteria growth. However at this temperature it takes one second for a severe burn or scald to occur! Temp-de-Tech™ is designed to ensure water is delivered at a temperature of not more than 120°F, providing it is correctly installed and operated. With Temp-de-Tech™ installed, the bath water cannot reach higher than this temperature, thereby protecting people from risk of exposure to scalding. Its quick shut-down action also assists in prevention of scalding should the hot water be turned on, or the cold water be accidentally turned off or interrupted.

**INSTALLATION INSTRUCTIONS - YOU WILL NEED PLUMBERS TAPE**

**STEP 1** Ensure that the hot & cold taps are turned off. Remove the spout from the wall by turning it counter-clockwise. Inserting a long screwdriver into the spout using it as a lever may make this easier.

**IMPORTANT:** In addition to the thread required to refit the spout to the wall connection, Temp-de-Tech™ requires 0.2" of thread up the spout. If there is insufficient thread in the spout. If the thread is insufficient Temp-de-Tech™ should not be installed.

**STEP 2** Apply the plumbers thread tape to seal the threads of your Temp-de-Tech™ & using the tools provided, screw your Temp-de-Tech™ into the spout as shown below.

**STEP 3** Apply plumbers thread tape to seal the threads of the wall connection & refit the bath spout onto the wall connection.

**Direction of flow**

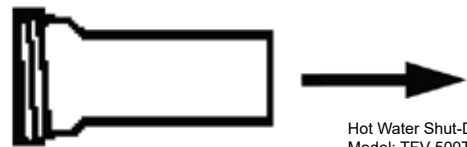

Hot Water Shut-Down Valve  
Model: TFV-500TH

**OPERATION**

For normal operation, first turn on the cold water to achieve the desired flow rate, then introduce hot water until the preferred temperature is reached.

**RESET**

When Temp-de-Tech™ shuts down the hot water flow, turn off the hot tap, stand clear of the flow and open the cold tap. Temp-de-Tech™ will reset as soon as the hot water is purged from the pipes.

Turn on the cold water to achieve the desired flow rate, then introduce hot water until the preferred temperature is reached.

**TEST**

When testing, ensure that no person is in the line of flow of water.

Have a strong flow of warm water pass through the spout, then close the cold tap & observe the water shut-down.

Once the shut-down has occurred this product will reduce the flow of hot water to a trickle. This continuation of water flow is necessary to allow resetting to occur. **It is recommended that this product be tested monthly.**

**WARNING:**

This product is designed to reduce the incidence of scalding; however hot water will trickle from the unit when shut-down occurs.

Bath fittings fitted with this product should not be operated by children without parental supervision.

This product may not operate properly if incorrectly installed.

It is recommended that this product be replaced if test failure occurs.

This product is not a substitute for Tempering Valves or Thermostatic Mixing Valves.

This product is not suitable for use in Health Care Institutions.

**IMPORTANT:** ENSURE TAP SPOUT IS SECURELY

FIXED PRIOR TO FITTING TEMP-DE-TECH™.

NOTE: TEMP-DE-TECH™ IS AVAILABLE IN TWO

TYPES – INTERNAL AND EXTERNAL THREAD.

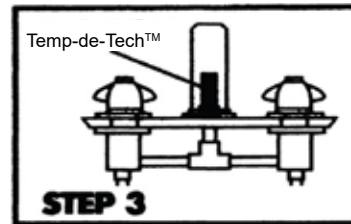
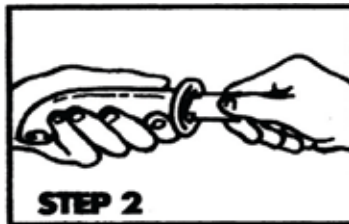

JL Industries, inc.

**Precision Plumbing Products**

Division of JL Industries, Inc.

802 SE 199th Ave  
Portland, Oregon 97233

T (503) 256-4010  
F (503) 253-8165

www.pppinc.net





**Precision Plumbing Products**  
*"Specify with Confidence - Install with Pride"*

**LEAD FREE**

**TEMP-DE-TECH**

**VALVE SPECIFICATION**

Hot water supply temperature	185°F max
Water supply pressure static	200 psi max.
Flow rate:	
Normal	2.5 gpm
Shut-down	less than 0.25 gpm
Nominal Set temperature	120°F (+/- 3°F)
Max. Operating Pressure	145 psi
Min. Operating Pressure	less than 1 psi

**INSTALLATION INSTRUCTIONS**

www.pppinc.net

**ASSE 1062**

**Nominal Size 1/2"**

**Direction of flow**



Hot Water Shut-Down Valve  
Model: TLV-500

Proposition 65 Warning (for California Residents Only)  
 This product contains a chemical known to the State of California to cause cancer, birth defects or other reproductive harm.

**NOTE TO INSTALLER/CONTRACTOR:** California law requires this notice to be provided to the consumer/end user of this product.

**FUNCTION**

Storage hot water systems should deliver water at a minimum of 140°F to prevent bacteria growth. However at this temperature it takes one second for a severe burn or scald to occur!

Temp-de-Tech™ is designed to ensure water is delivered at a temperature of not more than 120°F, providing it is correctly installed and operated. With Temp-de-Tech™ installed, the risk from exposure to scalding is reduced should the hot water be turned on, or the cold water be accidentally turned off or interrupted.

**INSTALLATION INSTRUCTIONS**

STEP 1 Ensure that the hot & cold taps are turned off. Remove the aerator from the spout by turning it counter-clockwise. A wrench may be required.

STEP 2 Screw the Temp-de-Tech™ into the spout as shown below. Hand tighten only!

Note: Use a sufficient number of the washers supplied to give the required seal between the Temp-de-Tech™ & spout.

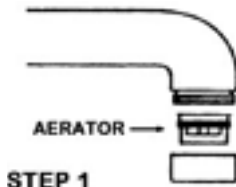

**OPERATION**

For normal operation, first turn on the cold water to achieve the desired flow rate, then introduce hot water until the preferred temperature is reached.

**RESET**

When Temp-de-Tech™ shuts down the hot water flow, turn off the hot tap, stand clear of the flow and open the cold tap. Temp-de-Tech™ will reset as soon as the hot water is purged from the pipes.

Turn on the cold water to achieve the desired flow rate, and then introduce hot water until the preferred temperature is reached.

**TEST**

When testing, ensure that no person is in the line of flow of water.

Have a strong flow of warm water pass through the spout, then close the cold tap & observe the water shut-down.

Once the shut-down has occurred this product will reduce the flow of hot water to a trickle. This continuation of water flow is necessary to allow resetting to occur. **It is recommended that this product be tested monthly.**

**WARNING:**

If the outlet of the Temp-de-Tech™ is below the maximum possible water level, a backflow prevention device must be fitted.

This product is designed to reduce the incidence of scalding; however hot water will trickle from the unit when shut-down occurs.

Tap fittings fitted with this product should not be operated by children without parental supervision.

This product may not operate properly if incorrectly installed.

It is recommended that this product be replaced if test failure occurs.

This product is not a substitute for Tempering Valves or Thermostatic Mixing Valves.

This product is not suitable for use in Health Care Institutions.

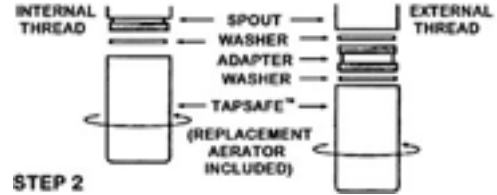

**STEP 2**

**IMPORTANT:** ENSURE TAP SPOUT IS SECURELY FIXED PRIOR TO FITTING TEMP-DE-TECH™.

NOTE: TEMP-DE-TECH™ IS AVAILABLE IN TWO TYPES – INTERNAL AND EXTERNAL THREAD.

**Precision Plumbing Products**

Division of JL Industries, Inc.



802 SE 199th Ave  
Portland, Oregon 97233

T (503) 256-4010  
F (503) 253-8165

www.pppinc.net

